

# JOE ARMITAGE

---

## Armitage Desk Lamp

### Assembly Guide

---

#### PREPARATION

Please read instructions thoroughly before installation and keep them for future reference. Please take extreme care when dealing with electrical equipment.

#### IMPORTANT

Bulb must be installed in fixture before turning on.

#### WARNING

Ensure power is turned OFF before inserting plug.

#### CARE AND CLEANING

We recommend cleaning with a soft dry cloth. Do not use abrasive materials as these will damage the finish of the product.

#### WARRANTY AND AFTER-CARE

This product has a three-year warranty. If there appears to be a functional defect with the product during this time, please contact us at: [info@joearmitage.com](mailto:info@joearmitage.com).

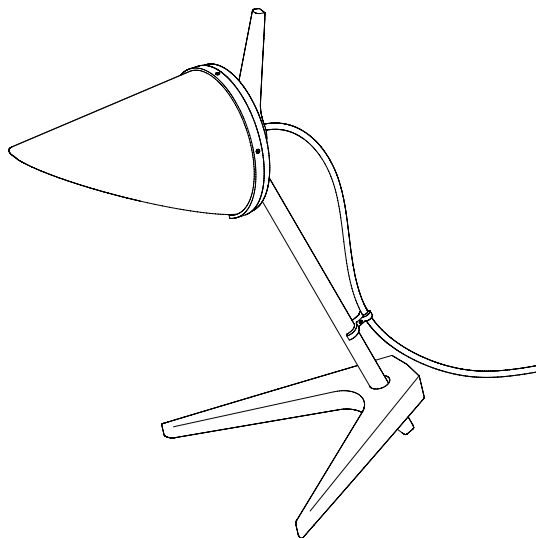

IP20

220 - 240V



## COMPONENTS

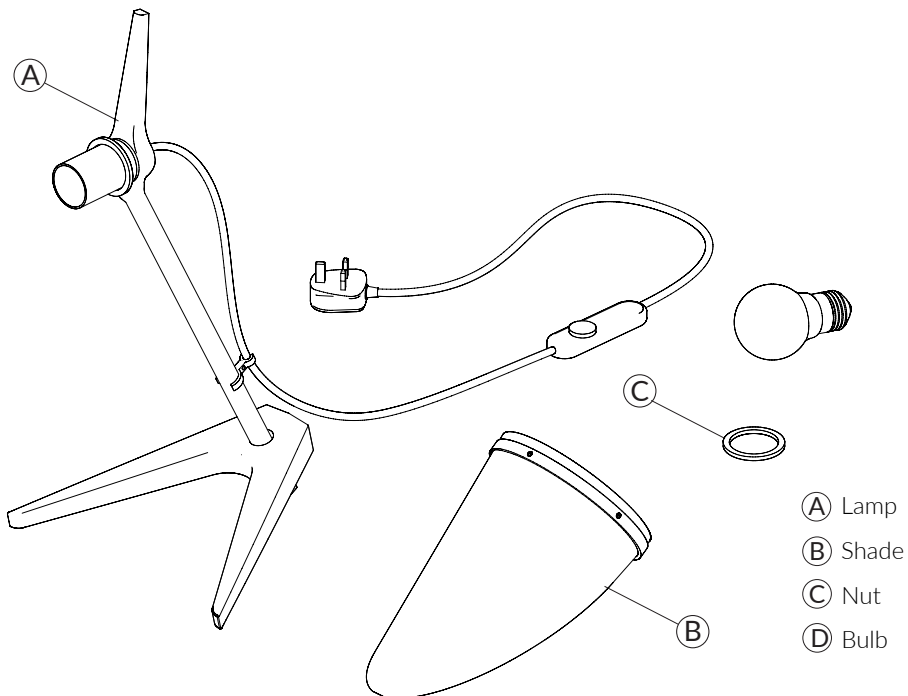

### STEP 1

Slide the shade (B) onto threaded lamp holder.

Twist the brass nut (C) onto the threaded lamp holder until the shade is tightly fastened.

Check the shade is in the correct orientation (open side of the shade facing down) before fully tightening the nut.

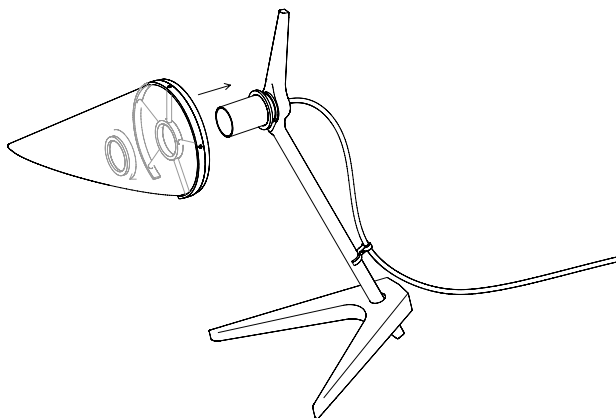

## STEP 2

Screw bulb **D** into the lamp holder. Rotating clockwise until tight.

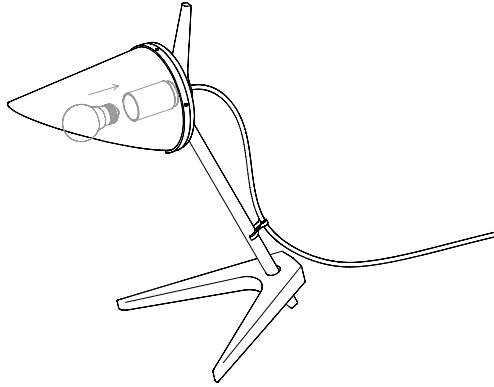

---

## STEP 3

Insert the lamp plug into your chosen wall socket and then switch the power on.

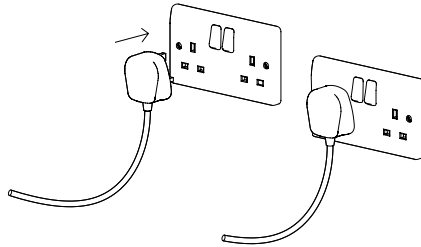

---

## STEP 4

Rotate the dial on your dimmer until the bulb lights up. Adjust the dimmer for your desired light output.

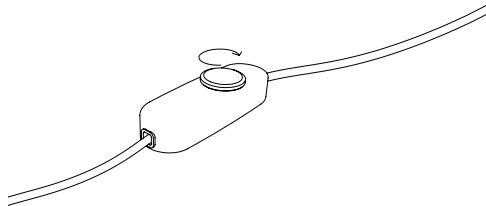

**Stay connected**

Instagram: @joearmitagedesign | Tag: joearmitage | info@joearmitage.com